

# Freestanding Tub

LUXART® *AltaBella*

## Product Specifications

LUXART®

# PINEHURST®

## PINEHURST5932

Luxart® ALTABELLA tubs are made from vacuum-formed acrylic sheets and have a deep, durable color layer. These versatile tubs are strong and lightweight, serving as the centerpiece of your bathroom. Pour into an AltaBella bath and enjoy a generous, deep soak like no other.

## TECHINCAL SPECIFICATIONS

|                        |                     |
|------------------------|---------------------|
| Height                 | 22.8 in             |
| Width                  | 31.5 in             |
| Depth                  | 17.5 in             |
| Length                 | 59.06 in            |
| Weight                 | 88 pounds           |
| Shipping Weight        | 103 pounds          |
| Capacity (full)        | 66 Gallons          |
| Capacity (to overflow) | 60 Gallons          |
| Drain                  | Center              |
| Overflow               | Integrated          |
| Faucet Type            | Wall or Floor Mount |

## APPLICABLE STANDARDS/CODES

Specified model meets or exceeds the following:

- CSA B45.5-11/IAPMO Z124

## Warranty

See warranty information for more details.

All dimensions listed are nominal. LUXART® reserves the right to make product and material changes at any time without notice.

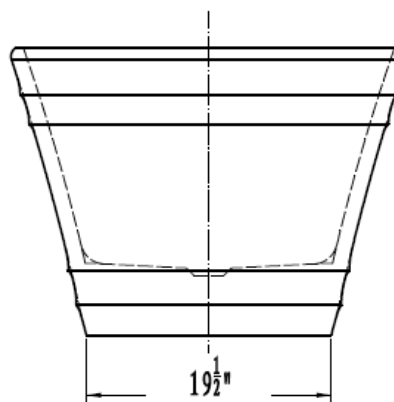
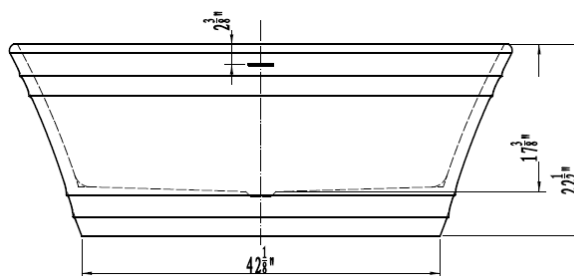
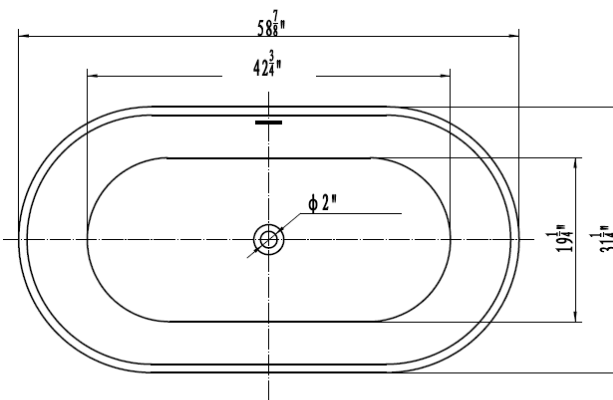

Contact your sales representative for more information or visit our website at [luxartcollection.com](http://luxartcollection.com)

# Freestanding Tub

LUXART® *Alta Bella*

## Product Specifications

### TECHINCAL SPECIFICATIONS

Metal overflow drain cover. Integral bathtub drain assembly with integral overflow holes. Metal pop-up drain cover. Drain cover is interchangeable with different finish colors, purchased separately. Made of brass and metal components.

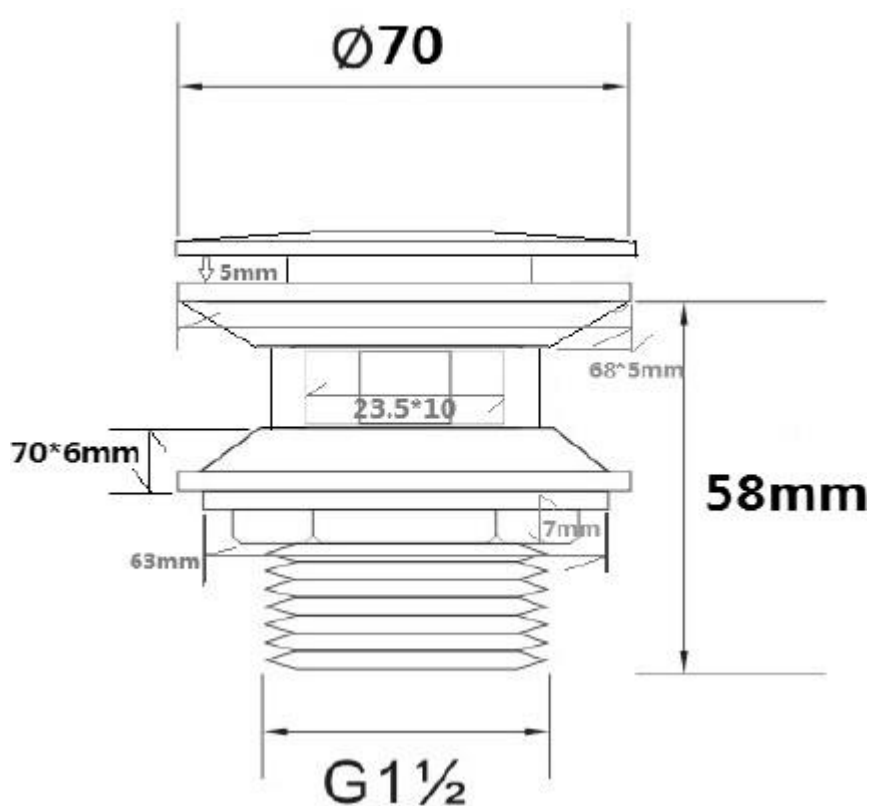

Contact your sales representative for more information or visit our website at [luxartcollection.com](http://luxartcollection.com)

Revised 9/18/2023