

FEATURES

- Custom front panel and hardware allow for infinite design options.
- Integrated design allows for dual installation and point-of-use refrigeration.
- Interactive smart-touch control panel.
- Advanced water filtration system.
- LED lit interior.
- Adjustable wire shelves and door shelves.
- Capacious freezer storage drawers.
- Door alarm and smart home features.
- Automatic ice maker with max ice feature temporarily increases production.

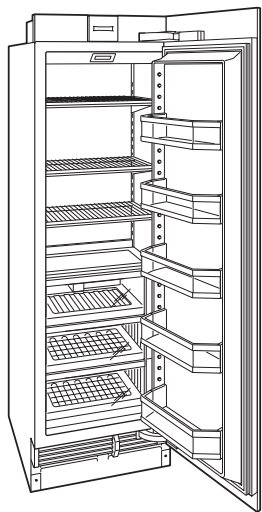

Model IC-24FI



MODEL OPTIONS

All Freezer IC-24FI

Specify RH or LH door.

INTERIOR FEATURES

FREEZER

- 3 Adjustable wire shelves
- 2 Storage drawers
- 5 Adjustable door shelves
- Ice drawer
- Automatic ice maker

ACCESSORIES

- Stainless steel front panel with tubular or pro handle.
- Stainless steel top and side enclosure panels.
- Stainless steel tubular and pro handles.
- Dual installation kit for installation with column or tall model.
- Stainless steel kickplate.
- Air deflector for reduced toe kick.
- Replacement water filter.

Accessories available through an authorized Sub-Zero dealer. For local dealer information, visit the find a showroom section of our website, subzero.com.

SPECIFICATIONS	
PRODUCT	
Dimensions	24"W x 84"H x 24"D
Door Clearance	22 1/2"
Weight	340 lb
CAPACITY	
Freezer	12.3 cu ft
ELECTRICAL	
Supply Service	115 VAC, 60 Hz 15 amp circuit
PLUMBING	
Supply Pressure	1/4" OD copper, braided stainless steel or PEX tubing 35–120 psi

Product dimensions do not include panel or handle and will vary with panel thickness. Allow for panel thickness when planning the finished opening depth.

Specifications are subject to change without notice. Visit subzero.com/specs for the most up-to-date information.

Dimensions may vary ±1/8" (3). Dimensions in parentheses are millimeters unless otherwise specified.

DIMENSIONS

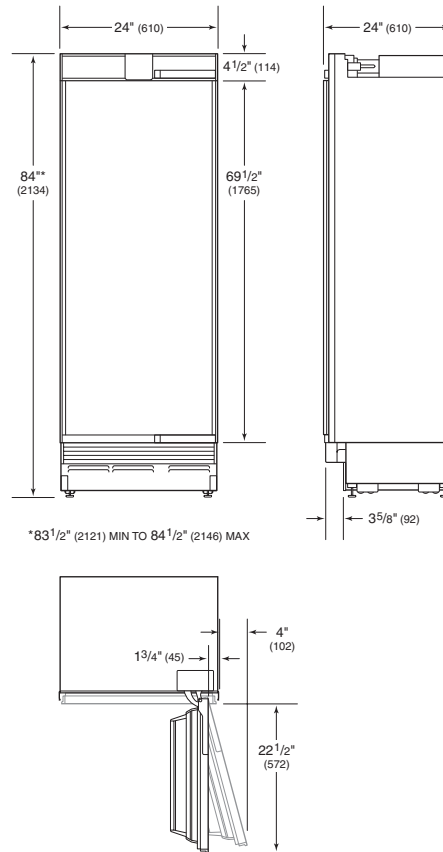

ELECTRICAL

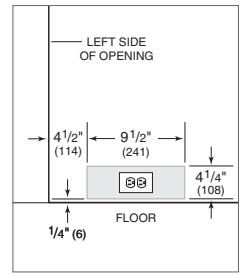

PLUMBING

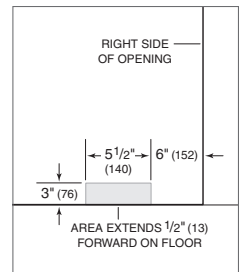

INSTALLATION

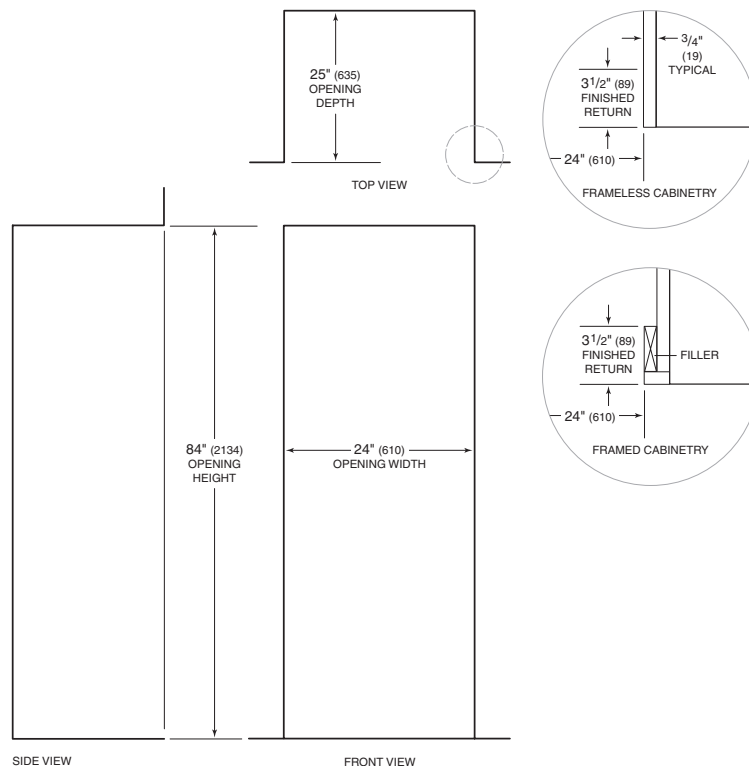

NOTE: 3 1/2" (89) finished returns will be visible and should be finished to match cabinetry.