

# U-BOLT MECHANICAL TEE (SADDLE-LET)

## Model 300U



The Model 300U Saddle-Lets is the ideal outlet fitting for direct connections to sprinkler heads, drop nipples and or gauges. No need for welding, just cut or drill a hole at the desired outlet location. Position the Saddle-Let so that the locating collar fits within the hole and secure with the U-bolt and nuts. The Saddle-Let allows full bore flow and is pressure rates to 300 psi (20 bar).

### Pipe Material

- Carbon steel, Schedule 10, Schedule 40.
- For use with alternative materials and wall thicknesses please contact ARGCO.

### Maximum Working Pressure

- Up to 365 psi/2517 kPa.

### Function

- Joins carbon steel pipe.
- Provides a rigid pipe joint designed to restrict axial or angular movement.

### CERTIFICATIONS/LISTINGS

Underwriters Laboratories, Underwriters Laboratories Canada, Factory Mutual.

### SPECIFICATIONS - MATERIAL

**Housing Sections:** Ductile Iron conforming to ASTM A 536, Grade 65-45-12.

### Housing Coating:

Standard: Orange Enamel

Available: Hot Dipped Galvanized

### Gasket:

Standard: Grade E EPDM (Type A)

ARGCO's products are listed by Underwriters Laboratories UL Canada and Approved by Factory Mutual for we and dry (oil free air) sprinkler services within the rated working pressure.

### Bolts and Nuts

Standard: Carbon Steel oval neck track bolts meeting ASTM A449 and ISO 898-1. Carbon steel hex nuts meet ASTM A563 Grade B.

Nuts and Bolts are zinc electroplated per ASTM B633 NZ/FE5, finish Type III.

Available: Stainless Steel. Meets ASTM F593, Group 2 (316 stainless steel), condition CW.

Hex nuts meets ASTM F594, Group 2 (316 stainless steel), condition CW, with galling-resistant coating.

System No.		Location		Spec Section		Paragraph	
Submitted By		Date		Approved		Date	

# U-BOLT MECHANICAL TEE

## Model 300U

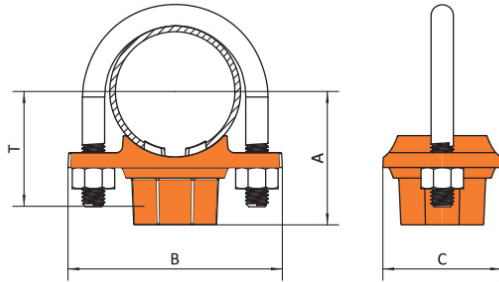

Item #	Nominal Size in/mm	Hole Dia. T +0.04, -0 +1, -0	Dimensions			Take-Out T/D in/mm	Bolt Size in	Bolt Torque N-M/Lbs-Ft
			A inches mm	B inches mm	C inches mm			
7010285	1-1/4 x 1/2 35 x 15	1.18 30	2.09 53	3.50 89	2.20 56	1.73 44	3/8 U-Bolt	22-29 30-40
7010286	1-1/4 x 3/4 32 x 20	1.18 30	2.09 53	3.50 89	2.20 56	1.73 44	3/8 U-Bolt	22-29 30-40
7010287	1-1/4 x 1 32 x 25	1.18 30	2.20 56	3.50 89	2.20 56	1.85 47	3/8 U-Bolt	22-29 30-40
7010288	1-1/2 x 1/2 40 x 15	1.18 30	2.17 55	3.50 89	2.20 56	1.81 46	3/8 U-Bolt	22-29 30-40
7010289	1-1/2 x 3/4 40 x 20	1.18 30	2.17 55	3.50 89	2.20 56	1.81 46	3/8 U-Bolt	22-29 30-40
7010290	1-1/2 x 1 40 x 25	1.18 30	2.28 58	3.50 89	2.20 56	1.93 49	3/8 U-Bolt	22-29 30-40
7010291	2 x 1/2 50 x 15	1.18 30	2.52 64	3.86 98	2.20 56	2.09 53	3/8 U-Bolt	22-29 30-40
7010292	2 x 3/4 50 x 20	1.18 30	2.52 64	3.86 98	2.20 56	2.09 53	3/8 U-Bolt	22-29 30-40
7010293	2 x 1 50 x 25	1.18 30	2.64 67	3.86 98	2.20 56	2.20 56	3/8 U-Bolt	22-29 30-40
7010294	2-1/2 x 1/2 65 x 15	1.18 30	2.72 69	4.37 111	2.20 56	2.28 58	3/8 U-Bolt	22-29 30-40
7010295	2-1/2 x 3/4 65 x 20	1.18 30	2.72 69	4.37 111	2.20 56	2.28 58	3/8 U-Bolt	22-29 30-40
7010296	2-1/2 x 1 65 x 25	1.18 30	2.83 72	4.37 111	2.20 56	2.40 61	3/8 U-Bolt	22-29 30-40

### User Responsibility for Product Selection and Suitability

Each user bears final responsibility for making a determination as to the suitability of ARGCO products for a particular end-use application, in accordance with industry standards and project specifications, and the applicable building codes and related regulations as well as ARGCO performance, maintenance, safety, and warning instructions. Nothing in this or any other document, nor any verbal recommendation, advice, or opinion from any ARGCO employee, shall be deemed to alter, vary, supersede, or waive any provision of Allied Rubber and Gasket Company's standard conditions of sale, installation guide, or this disclaimer.

### Note

All products to be installed in accordance with current ARGCO installation/assembly instructions. ARGCO reserves the right to change product specifications, designs and standard equipment without notice and without incurring obligations.

### Installation

Reference should always be made to the ARGCO installation instructions of the product you are installing.

### Warranty

Refer to the Warranty section of the current Price List or contact ARGCO for details.



## VIZM.EX26459 Fittings, Rubber Gasketed

[Page Bottom](#)

### Fittings, Rubber Gasketed

[See General Information for Fittings, Rubber Gasketed](#)

ALLIED RUBBER & GASKET CO INC, DBA ARGCO

EX26459

5400 S 66th St  
Fort Smith, AR 72903 USA

#### Coupling

Model	Groove Type	Pipe	Size (in.)	Rated Pressure (psig)
001	Rolled	10	2-1/2, 6, 8	300
001	Rolled	10, GB/T 3091	1, 1-1/4, 1-1/2, 2, 3, 4, 5	300
001	Rolled	GB/T 3091	3OD, 5-1/2OD, 6-1/2OD	300
001	Rolled, Cut	40	1-1/4, 1-1/2, 2, 3, 4, 5, 6, 8	300
001	Rolled, Cut	40, GB/T 17395	2-1/2, 10, 12	300
001	Rolled, Cut	GB/T 17395	5-1/4OD, 6-1/4OD	300
001	Rolled, Cut	GB/T 17393	10, 12	300
001	Rolled, Cut	BS EN10255	1, 5-1/2 OD	300
101	Rolled	10	1", 1-1/4", 1-1/2", 2", 2-1/2", 3", 4", 5", 6", 8", 10"	300
101	Cut, Rolled	40	1", 1-1/4", 1-1/2", 2", 2-1/2", 3", 4", 5", 6", 8", 10", 12"	300
101	Rolled	GB/T3091	3 OD (76.1 mm), 5-1/2 OD (139.7 mm), 6-1/2 OD (165.1 mm)	300
101	Rolled	Fire-Flo Schedule 7	1-1/4", 1-1/2", 2", 2-1/2", 3", 4"	300
103	Cut, Rolled	40	1", 1-1/4", 1-1/2", 2", 2-1/2", 3", 4", 5", 6", 8", 10", 12"	300
103	Cut, Rolled	GB/T3091	2-1/2" (76.1 mm), 5" (139.7 mm)	300
103	Cut, Rolled	GB/T3092	6" (165 mm)	300
106	Cut	40	4", 6", 8"	500
106	Cut	GB/T8163	5"	500
107	Rolled	10	1, 1-1/4, 1-1/2, 2, 2-1/2, 3, 4, 5	500
107	Rolled	10	6, 8	450
107	Rolled	10	10	400
107	Cut, Rolled	40	1, 1-1/4, 1-1/2, 2, 2-1/2, 3, 4, 5	500
107	Cut, Rolled	40	6, 8	450
107	Cut, Rolled	40	10, 12	400
107	Cut, Rolled	GB/T3091	3 OD (76.1 mm), 5-1/2 OD (139.7 mm)	500
107	Cut, Rolled	GB/T3091	6-1/2 OD (165.1 mm)	450

Model	Groove Type	Pipe	Size (in.)	Rated Pressure (psig)
101	Rolled	10	2-1/2, 6, 8, 10, 12	300
101	Rolled	10, GB/T 3091	1, 1-1/4, 1-1/2, 2, 3, 4, 5	300
101	Rolled	GB/T 3091	3OD, 5-1/2OD, 6-1/2OD	300
101	Rolled, Cut	40	1, 1-1/4, 1-1/2, 2, 3, 4, 5, 6, 8, 10, 12	300
101	Rolled, Cut	40, GB/T 17395	2-1/2	300
101	Rolled, Cut	GB/T 17395	5-1/4OD, 5-1/2OD, 6-1/4OD, 10, 12	300
101	Rolled, Cut	BS EN10255	1, 5-1/2OD	300
101	Rolled, Cut	GB/T17393	10, 12	300
101H	Rolled	10	1-1/4, 1-1/2, 2, 4, 6, 8, 10, 12	300
101H	Rolled, Cut	40	1-1/4, 1-1/2, 2, 4, 6, 8, 10, 12	300
101H	Rolled	GB/T3091 GB/T17395	1-1/4, 2, 3OD, 4, 5-1/2OD, 6-1/2OD	300
101H	Rolled, Cut	BS EN10255	1-1/4, 2, 3OD, 4, 5-1/2OD, 6-1/2OD	300
101H	Rolled, Cut	GB/T17395 GB/T17393	8, 10, 12	300
103	Rolled	Fire-Flo Schedule 7	1-1/4", 1-1/2", 2", 2-1/2", 3", 4"	300
103	Rolled	10	1-1/4", 1-1/2", 2", 2-1/2", 3", 4", 5", 6", 8"	300
104	Cut, Rolled	40	1", 1-1/4", 1-1/2", 2", 2-1/2", 3", 4", 5", 6", 8", 10", 12	300
104	Cut, Rolled	GB/T3091	2-1/2" (76.1 mm), 5" (127 mm)	300
104	Cut, Rolled	GB/T3092	6" (152 mm)	300
104	Rolled	Fire-Flo Schedule 7	1-1/4", 1-1/2", 2", 2-1/2", 3", 4"	300
104	Rolled	10	1-1/4", 1-1/2", 2", 2-1/2", 3", 4"	300
108	Rolled	10	1, 1-1/4, 1-1/2, 2, 2-1/2, 3, 3-1/2, 4, 5	500
108	Rolled	10	6	450
108	Cut, Rolled	40	1, 1-1/4, 1-1/2, 2, 2-1/2, 3, 3-1/2, 4, 5	500
108	Cut, Rolled	40	6, 8	450
108	Cut, Rolled	40	10, 12	400
108	Cut, Rolled	GB/T3091	3 OD (76.1 mm), 5-1/2 OD (139.7 mm)	500
108	Cut, Rolled	GB/T3091	6-1/2 OD (165.1 mm)	450

## Flange adapter

Model	Groove Type	Pipe	Size (in.)	Rated Pressure (psig)
007	Rolled	10	2-1/2, 6, 8	300
007	Rolled	10, GB/T 3091	2, 3, 4, 5	300
007	Rolled	GB/T 3091	3OD, 5-1/2OD, 6-1/2OD	300
007	Rolled, Cut	40	2, 3, 4, 5, 6, 8	300
007	Rolled, Cut	40, GB/T 17395	2-1/2	300
007	Rolled, Cut	GB/T 17395	5-1/4OD, 5-1/2 OD, 6-1/4OD	300
007	Rolled, Cut	BS EN10255	5-1/2OD	300

901	Cut, Rolled	40	2", 2-1/2", 3", 4", 5", 6", 8"	175
901	Cut, Rolled	GB/T3091	2-1/2" (76.1 mm), 5" (139.7 mm)	175
901	Cut, Rolled	GB/T3092	6" (165 mm)	175
902	Cut, Rolled	40	2", 2-1/2", 3", 4", 5", 6", 8"	250

## Side outlet

Model	Outlet Type	Pipe	Size (in.)	Rated Pressure (psig)
301	Grooved	10, 40	6x1-1/4, 1-1/2, 2, 2-1/2, 3OD, 3, 4; 8x1-1/4, 1-1/2, 2, 2-1/2, 3OD, 3, 4	300
301	Grooved	10, 40, GB/T 17395	2-1/2x1-1/4, 1-1/2, 2	300
301	Grooved	10, 40, BG/T 3091	2x1-1/4, 1-1/2; 3x1-1/4, 1-1/2, 2, 2-1/2, 3OD; 4x1-1/4, 1-1/2, 2, 2-1/2, 3OD, 3; 5x1-1/4, 1-1/2, 2, 2-1/2, 3OD, 3, 4	300
301	Grooved	GB/T 17395	5-1/4ODx1, 1-1/4, 1-1/2, 2, 2-1/2, 3OD, 3, 4; 6-1/4ODx1-1/4, 1-1/2, 2, 2-1/2, 3OD, 3, 4	300
301	Grooved	GB/T 3091	3ODx1-1/4, 1-1/2, 2; 5-1/2ODx1-1/4, 1-1/2, 2, 3OD, 3, 4; 6-1/2ODx1-1/4, 1-1/2, 2, 2-1/2, 3OD, 3, 4	300
301	Grooved	BS EN10255	5-1/2ODx1-1/4, 1-1/2, 2, 3OD, 3, 4	300
302	Threaded	10, 40	6x1/2, 3/4, 1, 1-1/4, 1-1/2, 2, 2-1/2, 3OD, 3; 8x1/2, 3/4, 1, 1-1/4, 1-1/2, 2, 2-1/2, 3OD, 3	300
302	Threaded	10, 40, GB/T 17395	2-1/2x1/2, 3/4, 1, 1-1/4, 1-1/2	300
302	Threaded	10, 40, GB/T 3091	1-1/4x1/2, 3/4, 1; 1-1/2x1/2, 3/4, 1; 2x1/2, 2x3/4, 1, 1-1/4, 1-1/2; 3x1/2, 3/4, 1, 1-1/4, 1-1/2, 2; 4x1/2, 3/4, 1, 1-1/4, 1-1/2, 2, 2-1/2; 5x1/2, 3/4, 1, 1-1/4, 1-1/2, 2, 2-1/2, 3OD, 3	300
302	Threaded	GB/T 17395	5-1/4ODx1/2, 3/4, 1, 1-1/4, 1-1/2, 2, 2-1/2, 3OD, 3; 5-1/2ODx1, 1-1/4, 1-1/2, 2, 2-1/2, 3OD, 3; 6-1/4ODx1/2, 3/4, 1, 1-1/4, 1-1/2, 2, 2-1/2, 3OD, 3	300
302	Threaded	GB/T 3091	3ODx1/2, 3/4, 1, 1-1/4, 1-1/2; 5-1/2ODx1, 1-1/4, 1-1/2, 2, 3OD, 3; 6-1/2ODx1, 1-1/4, 1-1/2, 2, 2-1/2, 3OD, 3	300
302	Threaded	BS 10255	5-1/2ODx1, 1-1/4, 1-1/2, 2, 3OD, 3	300
300U	Threaded	10,40	1-1/4x1/2, 3/4, 1; 1-1/2x1/2, 3/4, 1; 2x1/2, 3/4, 1; 2-1/2"x1/2, 3/4, 1; 4x1/2, 3/4, 1	300
300U	Threaded	BS EN10255 GB/T3091 GB/T17395	1-1/4x1/2, 3/4, 1; 1-1/2x1/2, 3/4, 1; 2x1/2, 3/4, 1; 3x1/2, 3/4, 1; 4x1/2, 3/4, 1	300

## Side outlet

Model	Outlet Type	Pipe	Size (in.)	Rated Pressure (psig)
020	Rolled	10	1-1/2x1-1/4, 2x1-1/4, 2x1-1/2, 2-1/2x2, 3x2, 3x2-1/2, 4x2, 4x2-1/2, 4x3OD, 4x3, 5-1/2ODx3, 5-1/2ODx4, 5x3, 5x4, 6-1/2ODx4, 6-1/2ODx5- 1/2OD, 6-1/2 OD x4, 6-1/2 OD x5-1/2OD, 6x4, 8x6	300
020	Rolled, Cut	40	1-1/2x1-1/4, 2x1-1/4, 2x1-1/2, 2-1/2x2, 3x2, 3x2-1/2, 4x2, 4x2-1/2, 4x3OD, 4x3, 5-1/2ODx3, 5-1/2ODx4, 5x3, 5x4, 6-1/2ODx4, 6-1/2ODx5- 1/2OD, 6-1/2 OD x4, 6-1/2 OD x5-1/2OD, 6x4, 8x6	300
020	Rolled	GB/T3091/	1-1/2x1-1/4, 2x1-1/4, 2x1-1/2, 3ODx2, 3x2, 3x3OD, 4x2, 4x3OD, 4x3,	300

## Pipe Fittings

These fittings are suitable for interconnecting piping, valves and other components in both wet and dry automatic sprinkler systems. Installation should be according to applicable sprinkler system fabrication rules. These rules limit the minimum size of sprinkler piping to 1 in., nominal. FM Approved pipe fittings of smaller sizes are intended for use as valve trim, gauge connections, and for other peripheral service. The water flow path of the sprinkler system cannot be designed using smaller sizes than 1 in., nominal. Unless otherwise noted in the listing, these fittings have 175 psi (1205 kPa) rated working pressure.

Threaded connections on fittings can be made to FM Approved threadable thinwall pipe or to Schedule 40 pipe. Refer to the "Steel Pipe" listings for a summary of the various types of FM Approved steel pipe suitable for threading or grooving."

The fittings manufacturer's installation instructions must be observed in all cases. When connections are made to FM Approved pipe, the pipe manufacturer's installation instructions must also be followed.

Unless otherwise stated below, the maximum ambient temperature to which these fittings should be subjected is 225°F (107°C).

### Fittings, Side Outlet, Rigid

These fittings allow installation of a perpendicular branch line of reduced size, while joining inline pipes of equal diameters. These fittings bolt over a hole in the run pipe, and allow installation of a perpendicular branch line of reduced size. The maximum branch line size is one pipe size reduced from the run pipe size.

### 301, 302, 300U

<i>Product Designation</i>	<i>Nominal Run by Outlet Sizes, mm</i>	<i>Fitting Description</i>	<i>Max Working Pressure, psi (kPa)</i>	<i>Remarks</i>
301	57x1, 57x1-1/4, 57x1-1/2, 2x1, 2x1-1/4, 2x1-1/2, 2-1/2x1, 2-1/2x1-1/4, 2-1/2x1-1/2, 2-1/2x2, 76x1, 76x1-1/4, 76x1-1/2, 76x57, 76x2, 3x1, 3x1-1/4, 3x1-1/2, 3x57, 3x2, 3x2-1/2, 3x76, 108x1, 108x1-1/4, 108x1-1/2, 108x57, 108x2, 108x76, 108x3, 4x1, 4x1-1/4, 4x1-1/2, 4x57, 4x2, 4x2-1/2, 4x76, 4x3, 133x1, 133x1-1/4, 133x1-1/2, 133x57, 133x2, 133x76, 133x3, 133x108, 133x4, 140x1, 140x1-1/4, 140x1-1/2, 140x57, 140x2, 140x76, 140x3, 140x108, 140x4, 5x1, 5x1-1/4, 5x1-1/2, 5x2, 5x2-1/2, 5x3, 5x4, 159x1, 159x1-1/4, 159x1-1/2, 159x57, 159x2, 159x76, 159x3, 159x108, 159x4, 165x1, 165x1-1/4, 165x1-1/2, 165x57, 165x2, 165x2-11/2, 165x76, 165x3, 165x108, 165x4, 6x1, 6x1-1/4, 6x1-1/2, 6x2, 6x2-1/2, 6x3, 6x4, 8x1, 8x1-1/4, 8x1-1/2, 8x57, 8x2, 8x2-1/2, 8x76, 8x3, 8x108, 8x4	Mechanical Tee (Grooved Outlet)	300 (2070)	a, b, c

302	<p>57x1/2, 57x3/4, 57x1, 57x1-1/4, 57x1-1/2, 2x1/2, 2x3/4, 2x1, 2x1-1/4, 2x1-1/2, 2-1/2x1/2, 2-1/2x3/4, 2-1/2x1, 2-1/2x1-1/4, 2-1/2x1-1/2, 2-1/2x2, 76x1/2, 76x3/4, 76x1, 76x1-1/4, 76x1-1/2, 76x2, 3x1/2, 3x3/4, 3x1, 3x1-1/4, 3x1-1/2, 3x2, 3x2-1/2, 3x76, 108x1/2, 108x3/4, 108x1, 108x1-1/4, 108x1-1/2, 108x2, 108x76, 108x3, 4x1/2, 4x3/4, 4x1, 4x1-1/4, 4x1-1/2, 4x2, 4x2-1/2, 4x76, 4x3, 133x1/2, 133x3/4, 133x1, 133x1-1/4, 133x1-1/2, 133x2, 133x76, 133x3, 140x1, 140x1-1/4, 140x1-1/2, 140x2, 140x76, 140x3, 5x1, 5x1-1/4, 5x1-1/2, 5x2, 5x3, 159x1/2, 159x3/4, 159x1, 159x1-1/4, 159x1-1/2, 159x2, 159x76, 159x3, 159x4, 165x1/2, 165x3/4, 165x1, 165x1-1/4, 165x1-1/2, 165x2, 165x2-1/2, 165x76, 165x3, 165x4, 6x1/2, 6x3/4, 6x1, 6x1-1/4, 6x1-1/2, 6x2, 6x2-1/2, 6x76, 6x3, 6x4, 8x1/2, 8x3/4, 8x1, 8x1-1/4, 8x1-1/2, 8x2, 8x2-1/2, 8x76, 8x3, 8x4</p>	Mechanical Tee (Threaded Outlet)	300 (2070)	-
300U	<p>1-1/4x1/2, 1-1/4x3/4, 1-1/4x1, 1-1/2x1/2, 1-1/2x3/4, 1-1/2x1, 2x1/2, 2x3/4, 2x1, 2-1/2x1/2, 2-1/2x3/4, 2-1/2x1, 3x1/2, 3x3/4, 3x1, 4x1/2, 4x3/4, 4x1</p>	U-Bolt Mechanical Tees (Threaded Outlet)	300 (2070)	a, b, c

**Remarks:**

- a. Min schedule cut groove pipe to be joined: 6 in. or smaller – Schedule 40; 8 in. or larger – Schedule 30.  
b. Min schedule rolled groove pipe to be joined: 6 in. or smaller – Schedule 10; 8 in. or larger – 0.188 in. (5 mm) wall.  
c. With EPDM gasket.

Company Name:	Allied Rubber & Gasket Company
Company Address:	5816 Dryden Place, Suite 101, Carlsbad, California 92008, USA